

**STRAINER BASKETS FOR ISO PN10/16 FLANGES**



**Size :** DN 50 to 300  
**Ends :** For flanges ISO PN10/16  
**Min Temperature :** - 20°C  
**Max Temperature :** + 200°C  
**Max Pressure :** 16 Bars  
**Specifications :** Mesh 6 mm  
With bolting

**Materials :** Steel or stainless steel

**STRAINER BASKETS FOR ISO PN10/16 FLANGES**

**SPECIFICATIONS :**

- For flanges ISO PN10/16
- Mesh 6 mm
- With bolting

**USE :**

- For water distribution and draining
- Min Temperature Ts : - 20°C
- Max Temperature Ts :+ 200°C
- Max Pressure PN : 16 bars

**RANGE :**

- Galvanized carbon steel strainer basket, for ISO PN10/16 flanges from DN50 to DN 150 and PN16 from DN 200 to DN 300 **Ref. 367**
- SS 304 strainer basket, for ISO PN10/16 flanges from DN50 to DN 300 **Ref. 376**

**MATERIALS :**

**REF. 367**



**REF. 376**



Designation	Materials Ref. 367	Materials Ref.376
Body	Galvanized carbon steel	SS 304

**STRAINER BASKETS FOR ISO PN10/16 FLANGES**

SIZE CARBON STEEL TYPE REF.367 ( in mm ) :

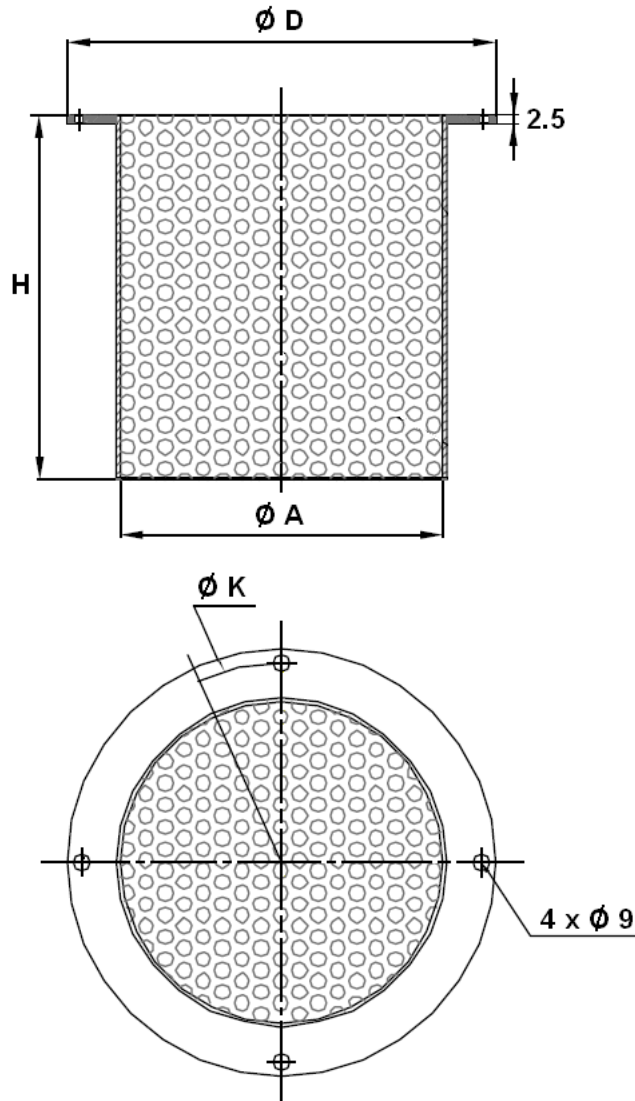

Ref.	DN	50	65	80	100	125	150	200	250	300
367	H	77	100	125	142	166	200	300	380	410
	$\varnothing A$	91	127	127	164	180	212	255	330	380
	$\varnothing D$	158	180	180	212	240	268	318	395	445
	$\varnothing K$	125	145	160	183	210	240	285	362	415
	Weight ( Kg )	0.593	0.758	0.825	1.213	1.492	1.809	2.783	4.376	5.379

## STRAINER BASKETS FOR ISO PN10/16 FLANGES

**SIZE STAINLESS STEEL TYPE REF.376 ( in mm ) :**

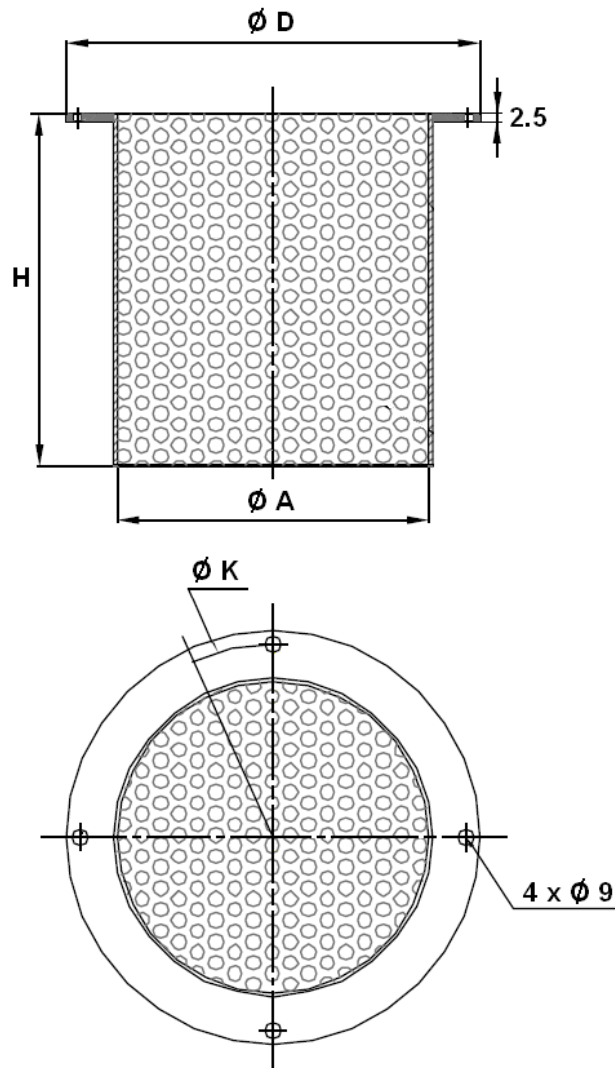

Ref.	DN	50	65	80	100	125	150	200	250	300
376	H	77	100	125	142	166	200	300	380	410
	Ø A	91	127	127	164	180	212	255	330	380
	Ø D	158	180	180	212	240	268	318	395	445
	Ø K	125	145	160	183	210	240	285	362	415
	Weight ( Kg )	0.426	0.746	0.858	1.096	1.432	1.796	2.527	4.5	5.386

## STRAINER BASKETS FOR ISO PN10/16 FLANGES

### STANDARDS :

- Fabrication according to ISO 9001: 2000
- DIRECTIVE 97/23/CE : Products excluded from directive (article 1, § 3.2)

**ADVICE :** Our opinion and our advice are not guaranteed and SFERACO shall not be liable for the consequences of damages. The customer must check the right choice of the products with the real service conditions.